

L6N



OIML test certificate no. D09-06.11 Revision 1
C of C no R60/2000-CN1-06.04

Certificate no. 11-055

- Aluminium-alloy IP65 single point load cell.
- Colourless anodized
- Suitable for single or double load cell structured platform scales
- Maximum platform size: 400 x 400 mm

Available models

Capacity	Accuracy	Full article description
3kg-100kg	Cx	L6N-Cx-xxkg-3B6/3YB6

Specification

Maximum capacity (E _{max})	kg	3/5/8/10/15/20/30/40/50/75/100		
Output sensitivity (= FS)	mV/V	2.0 ± 0.2		
Accuracy class		C3	C4	C5
Combined error	%FS	± 0.02	± 0.015	± 0.01
Creep	%FS/30 _{min}	± 0.0167	± 0.0125	± 0.01
Temperature effect on sensitivity	%FS/10	± 0.0175	± 0.0131	± 0.01
Temperature effect on zero	%FS/10	± 0.02	± 0.012	± 0.009
Zero balance	%FS	± 2		
Compensated temperature		- 10~ +40		
Operating temperature		- 35~ +65		
Input resistance		406 ± 6		
Output resistance		350 ± 3		
Insulation resistance	M	5000 (50VDC)		
Excitation, recommended voltage	V	5 ~ 12(DC)		
Excitation maximum	V	18(DC)		
Safe overload	%FS	120		
Ultimate overload	%FS	150		
Protection Class		IP65		
Recommended installation size	mm	400 × 400		
Corner correction		0.02%load value/100mm		
Recommended torque on fixation	N.m	10		

Dimensions in mm

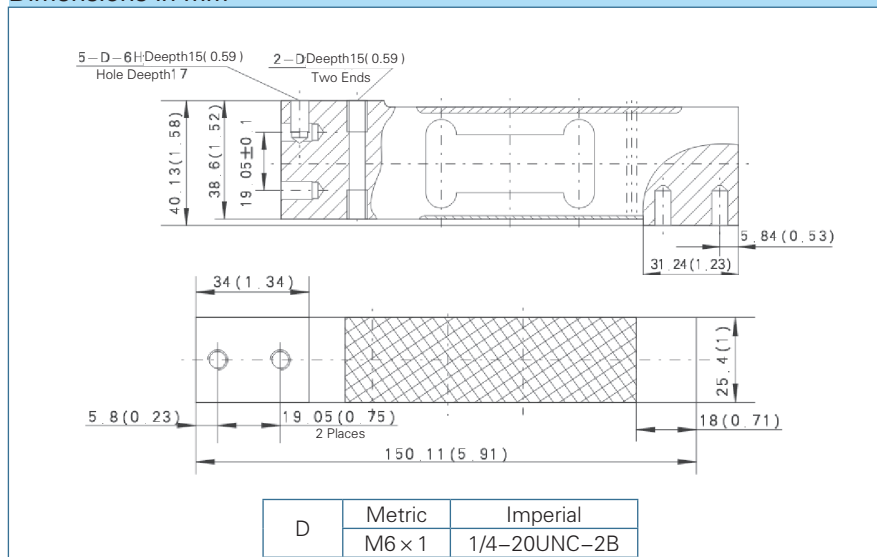

Wiring

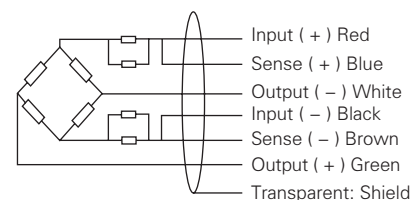

- Shielded, 6 conductor cable.
- Cable Diameter: Φ 4.8mm
- Standard cable length: 3m
- Shield not connected to element.
- Cable jacket is PVC.